

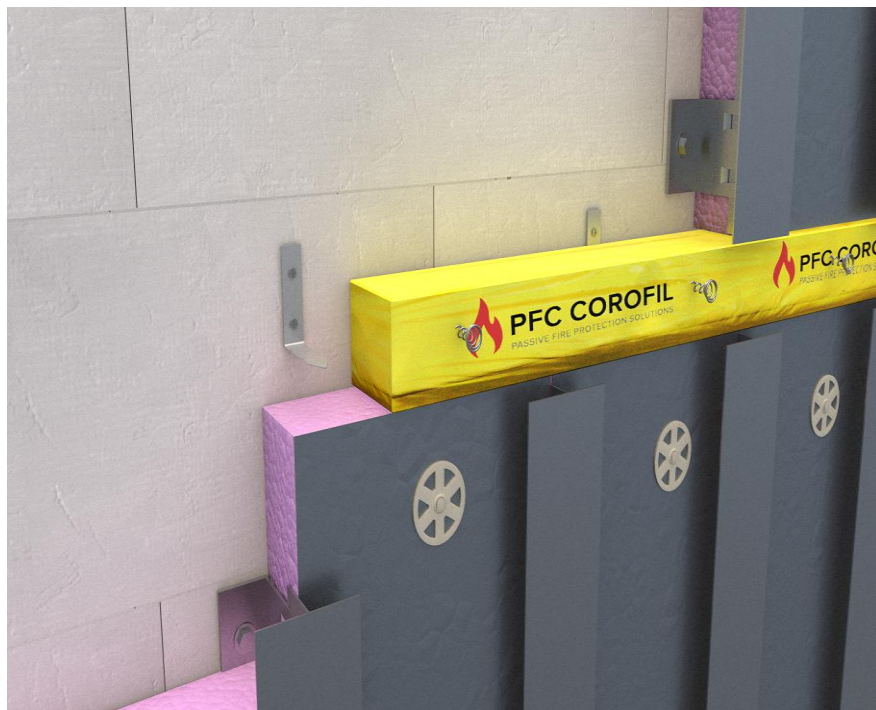

# PFC Corofil RSB2 Open State Cavity Barrier



## Application

PFC Corofil RSB2 open state cavity barrier is used to prevent the spread of fire for up to 60 minutes between horizontal or vertical cavities in external walls where a continuous air gap needs to be maintained.

## General benefits:

- The intumescent element of RSB2 expands to form a fire barrier between the inner substrate and back of the outer leaf.
- Suitable for cavities from 51mm to 300mm wide using OSB faced timber stud, concrete blocks faced with cement board and masonry/concrete substrates.
- Intumescent material expands to fill a continuous air gap of up to 25mm

## FIRE RATINGS

Tested to the principles of  
BS 476:Parts 20 & 22:1987  
BS EN 1363-1:1999

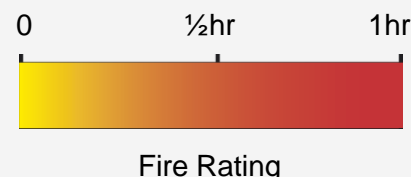

## TECHNICAL INFORMATION

Available from our technical sales office:

Email [tech@pfc-corofil.com](mailto:tech@pfc-corofil.com) for:

- Safety Data Sheet (SDRSBS)
- Installation Instructions (MSRSB2)

Manufactured using TENMAT FF107  
intumescent strip





# PFC Corofil RSB2 Open State Cavity Barrier

## Description

PFC Corofil RSB2 open state cavity barrier is manufactured to suit the overall cavity width, leaving a specified air gap (25mm wide). The finished product comprises a TENMAT FF107 intumescent strip and a rock mineral fibre backer enclosed in a polythene shrink wrap.

Where installed all insulation must be removed in the plane of the fire barrier.

## Specification

Install PFC Corofil RSB2 open state cavity barrier in horizontal and vertical Cavities to allow a ventilation and drainage gap.

Installation to be fully in accordance with manufacturer's instructions (see MSRSB2).

## Fire Rating

Substrate	Outer Face	Cavity Size	Fire Rating Integrity Horizontal	Fire Rating Integrity Vertical
Brick, Block, Masonry	Brick, Block, Masonry			
		51-200mm	60 mins	30 mins
Light weight aerated blocks	Lightweight aerated blocks	201-300mm	60 mins	90 mins
OSB Faced Timber Frame	Brick, Block, Masonry or Lightweight aerated blocks	51-300mm	60 mins	60 mins

Concrete blocks with  
Cement Board  
Facing  
Supporting rockfibre  
slab density range  
45-110kg/m3 Rated  
A1 to BSEN13501-1

Brick, Block,  
Masonry

51 to 200mm

60 mins

60 mins

## TECHNICAL INFORMATION

BS5Plus

H92 110

H92 120

P12 40

Please order from our technical sales office.

PFC Corofil  
Units 3-4  
King George Trading Estate  
Davis Road  
Chessington  
Surrey KT9 1TT

Tel: + 44 (0) 208 391 0533  
Fax: + 44 (0) 208 391 2723  
Email: [sales@pfc-corofil.com](mailto:sales@pfc-corofil.com)  
[www.pfc-corofil.com](http://www.pfc-corofil.com)