

PFC Corofil Intumescent Pipe Wrap

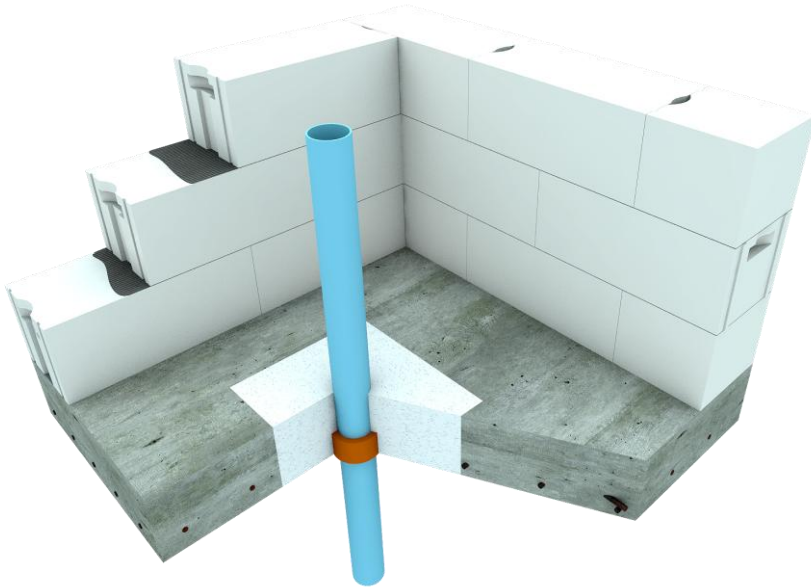

Application

PFC Corofil Intumescent Pipe Wraps offer an alternative to Firestop Collars for firestopping plastic pipework in masonry walls and concrete floors. The wraps are manufactured as a sealed unit to the correct length and width to suit the pipe diameter and fire rating. They are retained within the aperture of the construction element and held in place with the integral adhesive tape. The hole around the pipe wraps should be filled with PFC Corofil Firestop Compound (see MSCOMP).

Please see tables overleaf for pipe dimensions, materials and fire ratings.

Tested in accordance with BS 476 Part 20:1987 and BS EN 1366-3:2004 PFC Corofil Intumescent Pipe Wraps provide up to 4 hours fire protection.

General benefits:

- No mechanical fixings
- Integral self adhesive strip to aid installation
- Available to suit pipe sizes ranging from 32mm to 160mm outer diameter

Specification

Install PFC Corofil Intumescent Pipe Wraps to provide up to 4 hours fire protection to all plastic pipework. Installation to be fully in accordance with manufacturers instructions (see MSWRAP).

FIRE RATINGS

Tested to
BS 476 Part 20:1987
BS EN 1366-3:2003

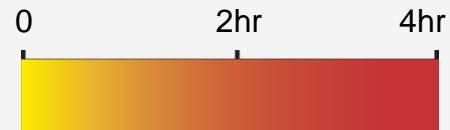

Fire Rating

TECHNICAL INFORMATION

Available from our technical sales office.

Email tech@pfc-corofil.com for:

- Safety Data Sheet (SDWRAP)
- Installation Instructions (MSWRAP)

IFC certification

Certificate number: FS453/06



P12 43
P12 44
P12 370
P12 375



PFC Corofil Intumescent Pipe Wrap

Fire rating installed in masonry or concrete wall or concrete floor slab

Pipe diameter (mm)	Pipe Wrap size Width x thickness (mm)	
	Integrity & Insulation performance EI120	EI240
30/32	50 x 4	N/A
38/40	50 x 4	N/A
55	50 x 4	50 x 8
63	50 x 8	N/A
75	50 x 8	N/A
82	50 x 8	N/A
90	50 x 8	N/A
110	50 x 8	100 x 8
125	100 x 20	N/A
160	100 x 20	100 x 20

Table of approved pipe types and wall thickness

Pipe Diameter (mm)	Approved Wall Thickness (mm)							
	PVC		HDPE		PP		ABS	
	Min	Max	Min	Max	Min	Max	Min	Max
32	1.8	2.0	3.0	3.4	1.8	2.2	1.8	2.2
40	1.9	2.1	3.0	3.5	1.9	2.3	1.9	2.3
50	2.0	2.2	3.0	3.5	2.2	2.4	2.0	2.4
55	2.0	3.2	3.0	3.5	2.2	2.4	4.0	4.5
82	3.0	3.45	3.0	3.5	2.6	5.0	N/A	N/A
110	3.2	3.6	4.2	5.0	3.4	5.3	N/A	N/A
160	3.2	3.8	6.2	7.1	4.8	5.3	N/A	N/A

The table above gives the approved wall thickness for pipe material and size combinations, but only where such pipe materials and sizes are approved. Inclusion of a pipe size, material and diameter in the table above does not necessarily imply approval for use .

Results can vary depending on the wall thickness of the pipe. Please contact the technical sales office tech@pfc-corofil.com to confirm that the product is suitable for your pipe configuration.

Not suitable for ventilated pipe applications or composite profile decking.

Please order from our technical sales office.

PFC Corofil
 Units 3-4
 King George Trading Estate
 Davis Road
 Chessington
 Surrey KT9 1TT

Tel: + 44 (0) 208 391 0533
 Fax: + 44 (0) 208 391 2723
 Email: sales@pfc-corofil.com
www.pfc-corofil.com