



Libra Systems

Internal Partition Single Skin Details



Contents

Metal Stud Partition System (Internal Partitions Single Skin)

ML/TYP/001	Standard head detail
ML/TYP/002	15 - 25mm / non fire rated deflection head
ML/TYP/003	15 - 25mm / 30 or 60 minute deflection
ML/TYP/004	head base detail
ML/TYP/005	internal and external corner detail
ML/TYP/006	abutment detail
ML/TYP/007	T Junction
ML/TYP/008	horizontal joint
ML/TYP/009	light / medium door opening
ML/TYP/010	light / medium door opening - section AA
ML/TYP/011	beam encasement / 60 minute

standard internal partition
standard head detail - fire rating as per system design
no deflection allowance

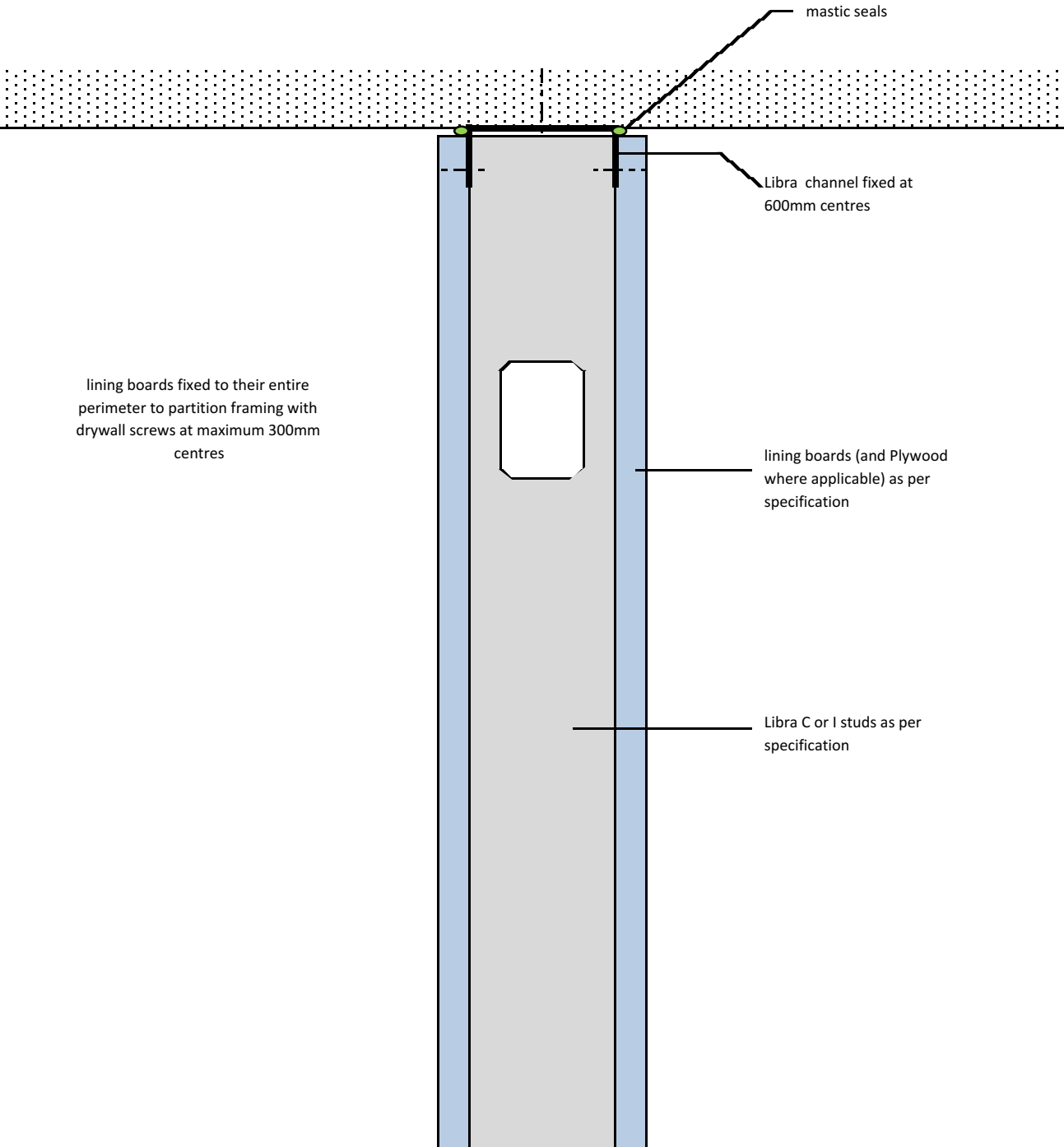

Notes: This drawing should be read in conjunction with the relevant sections of the manufacturers current product literature we would draw your attention to the Construction (Design and Management) Regulations 1994 and the Approved Code of Practice which detail the legal duties of clients, client's agents designers and contractors involved in construction projects.

for discussion purposes only / do not scale



project: Typical Detail		
initials: ML	date: 09/10/2017	drg no: ML/TYP/001

standard internal partition
15 - 25mm / non fire rated deflection head

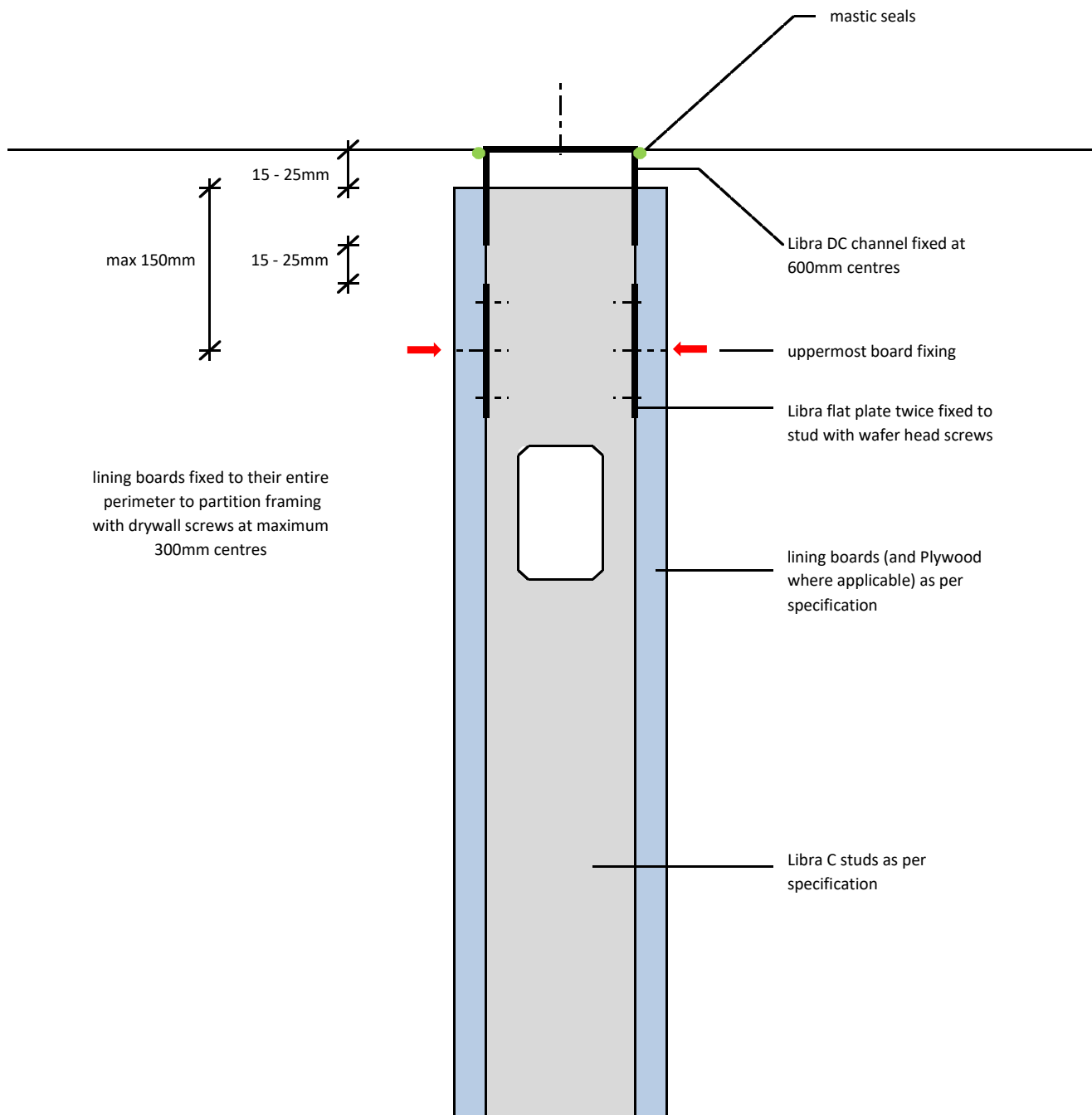

Notes: This drawing should be read in conjunction with the relevant sections of the manufacturers current product literature
we would draw your attention to the Construction (Design and Management) Regulations 1994 and the Approved Code of
Practice which detail the legal duties of clients, client's agents designers and contractors involved in construction projects.

for discussion purposes only / do not scale



project: Typical Detail		
initials: ML	date: 21/5/2017	drg no: ML/TYP/002

standard internal partition
15 - 25mm / 30 or 60 minute deflection head

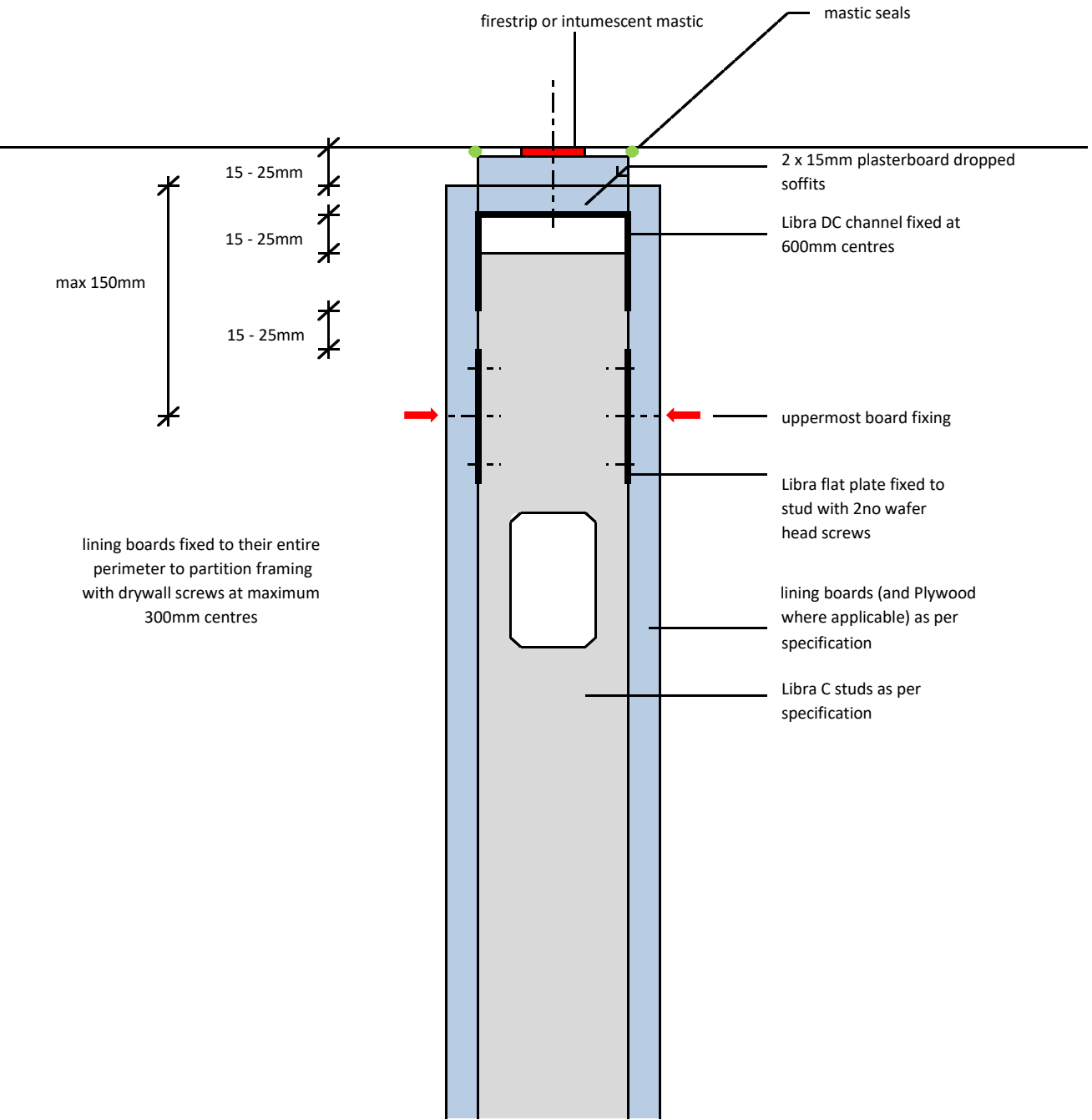

Notes: This drawing should be read in conjunction with the relevant sections of the manufacturers current product literature we would draw your attention to the Construction (Design and Management) Regulations 1994 and the Approved Code of Practice which detail the legal duties of clients, client's agents designers and contractors involved in construction projects.

for discussion purposes only / do not scale



project:
Typical Detail

initials:
ML

date:
21/5/2017

drg no:
ML/TYP/003

standard internal partition
base detail

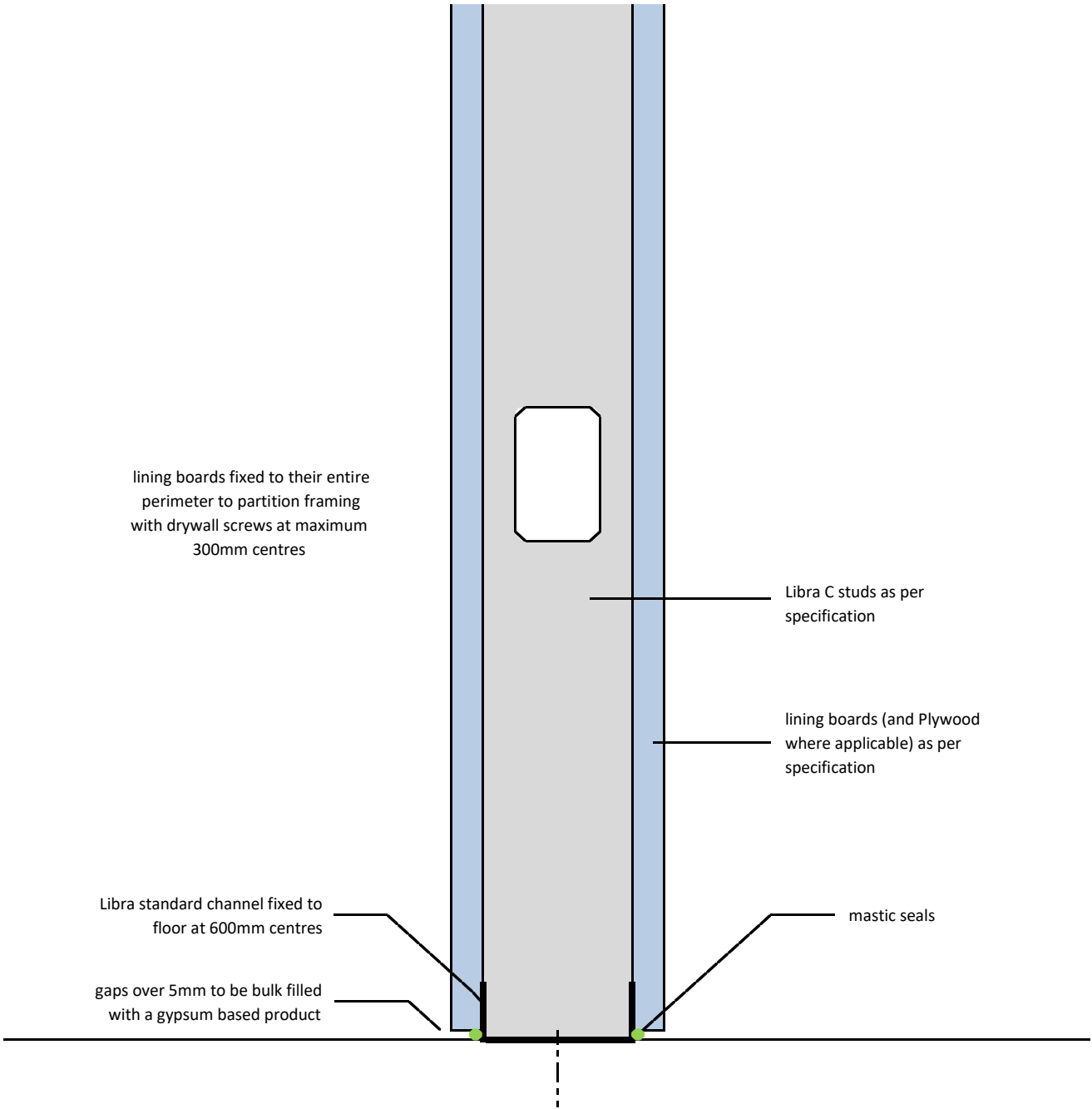

Notes: This drawing should be read in conjunction with the relevant sections of the manufacturers current product literature we would draw your attention to the Construction (Design and Management) Regulations 1994 and the Approved Code of Practice which detail the legal duties of clients, client's agents designers and contractors involved in construction projects.

for discussion purposes only / do not scale

	project: Typical Detail		
	initials: ML	date: 21/5/2017	drg no: ML/TYP/004

standard internal partition
internal and external corner detail

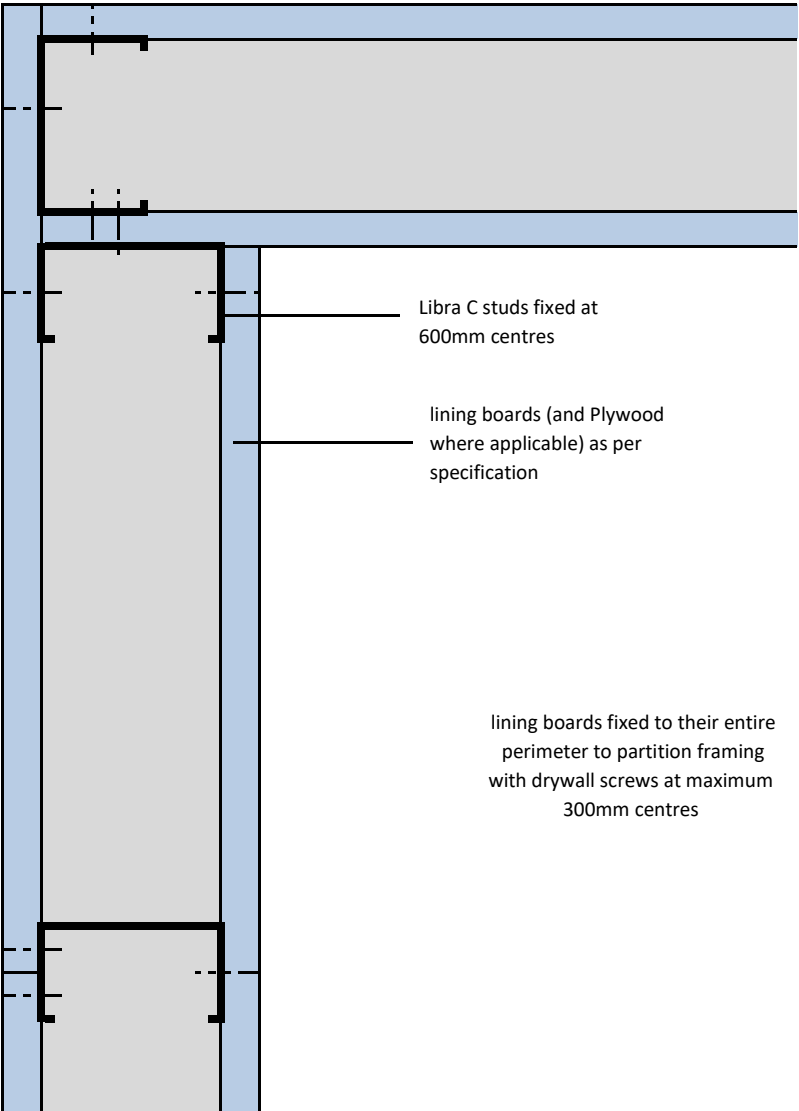

Notes: This drawing should be read in conjunction with the relevant sections of the manufacturers current product literature
we would draw your attention to the Construction (Design and Management) Regulations 1994 and the Approved Code of Practice which detail the legal duties of clients, client's agents designers and contractors involved in construction projects.

for discussion purposes only / do not scale

	project: Typical Detail		
	initials: ML	date: 21/5/2017	drg no: ML/TYP/005

standard internal partition
abutment detail

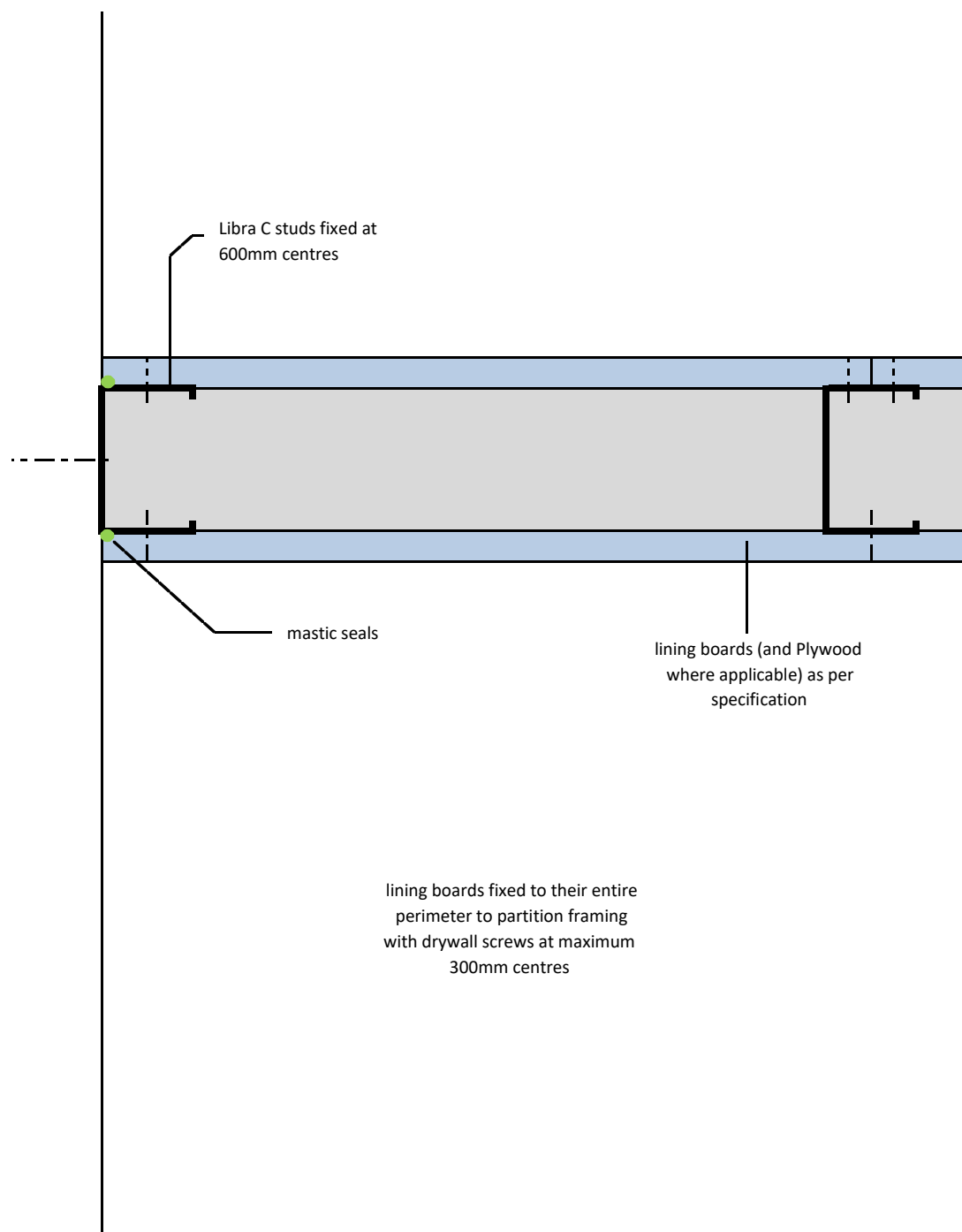

Notes: This drawing should be read in conjunction with the relevant sections of the manufacturers current product literature we would draw your attention to the Construction (Design and Management) Regulations 1994 and the Approved Code of Practice which detail the legal duties of clients, client's agents designers and contractors involved in construction projects.

for discussion purposes only / do not scale

	project: Typical Detail		
	initials: ML	date: 21/5/2017	drg no: ML/TYP/006

standard internal partition
T Junction

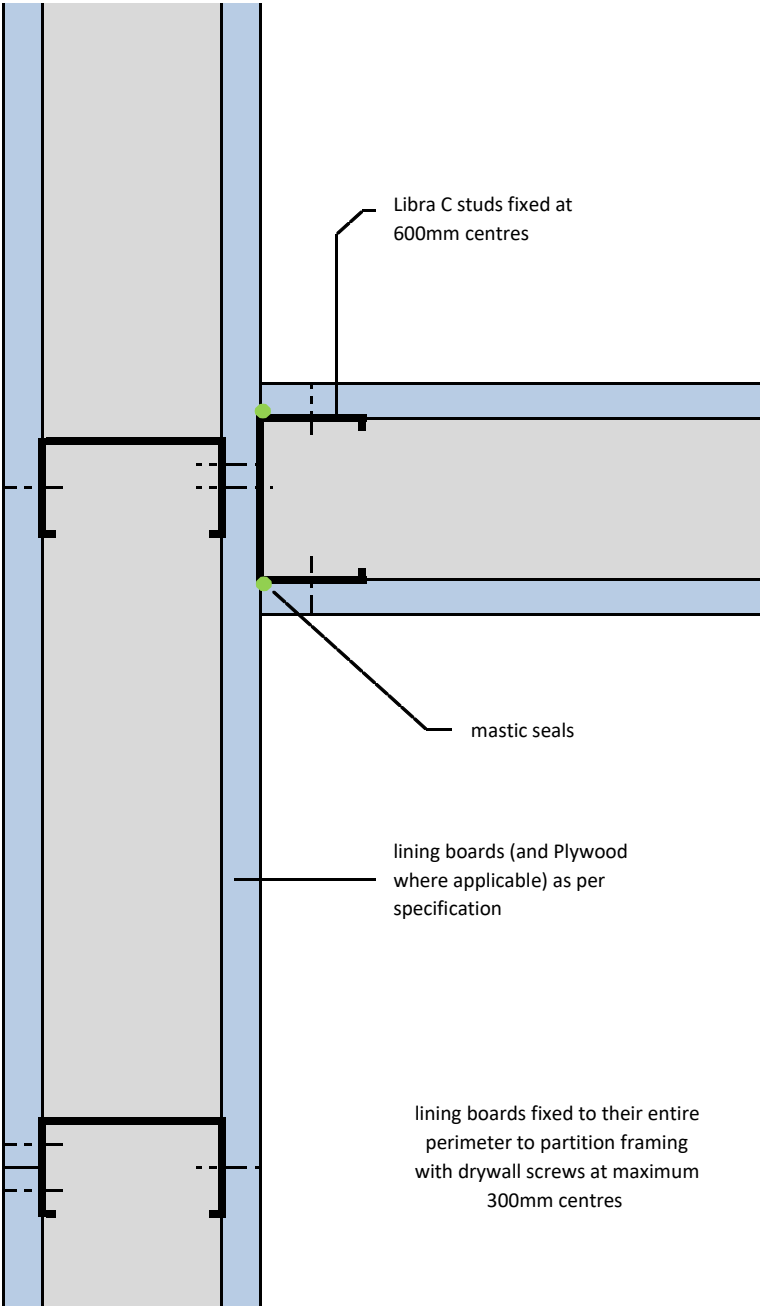

Notes: This drawing should be read in conjunction with the relevant sections of the manufacturers current product literature
we would draw your attention to the Construction (Design and Management) Regulations 1994 and the Approved Code of
Practice which detail the legal duties of clients, client's agents designers and contractors involved in construction projects.

for discussion purposes only / do not scale



project:	Typical Detail
----------	----------------

initials:
ML

date:
21/5/2017

drg no:
ML/TYP/007

standard internal partition
horizontal joint

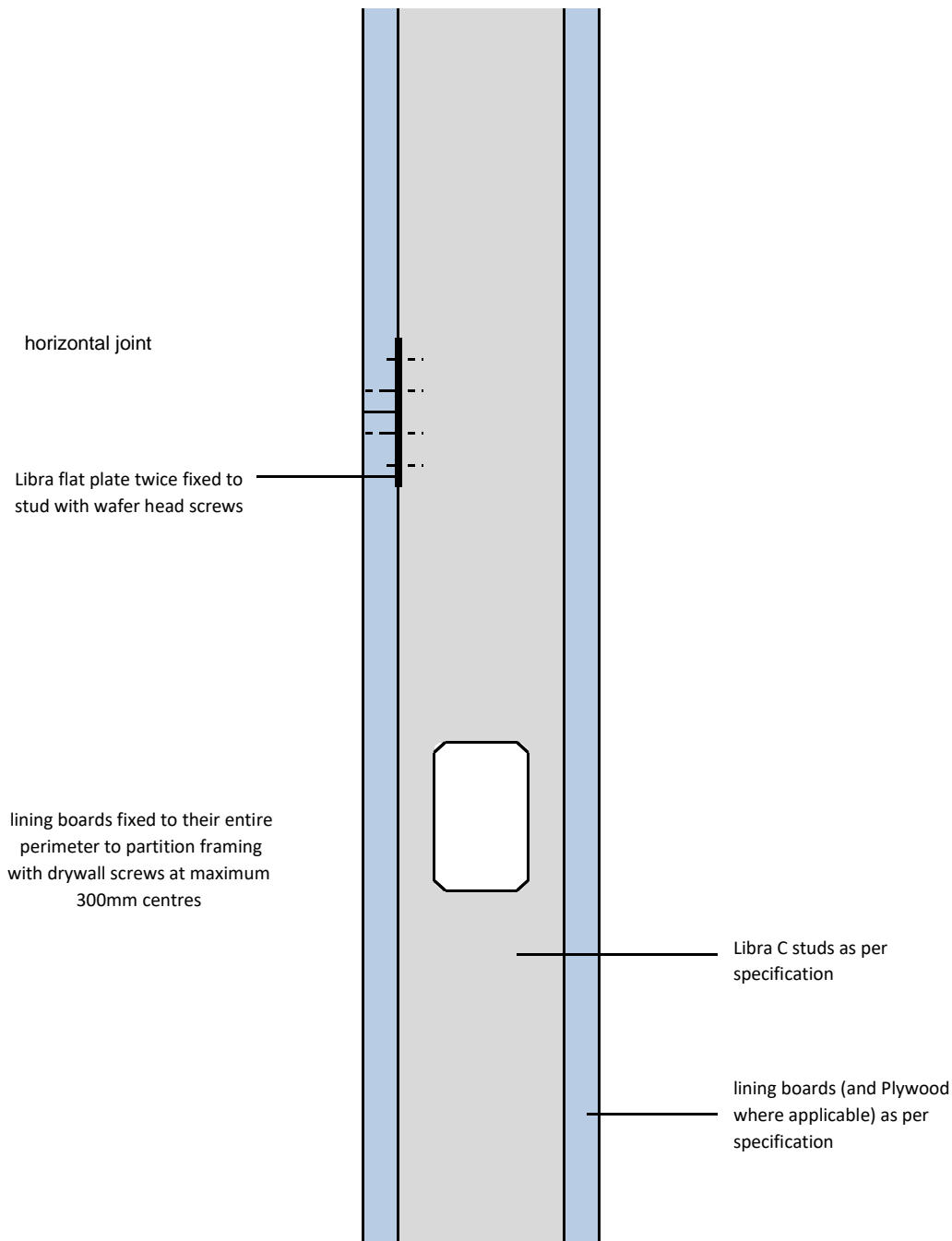

Notes: This drawing should be read in conjunction with the relevant sections of the manufacturers current product literature
we would draw your attention to the Construction (Design and Management) Regulations 1994 and the Approved Code of
Practice which detail the legal duties of clients, client's agents designers and contractors involved in construction projects.

for discussion purposes only / do not scale



project:	Typical Detail
----------	----------------

initials:
ML

date:
21/5/2017

drg no:
ML/TYP/008

standard internal partition
light / medium door opening

deflection head detail fixed to soffit at
600mm centres

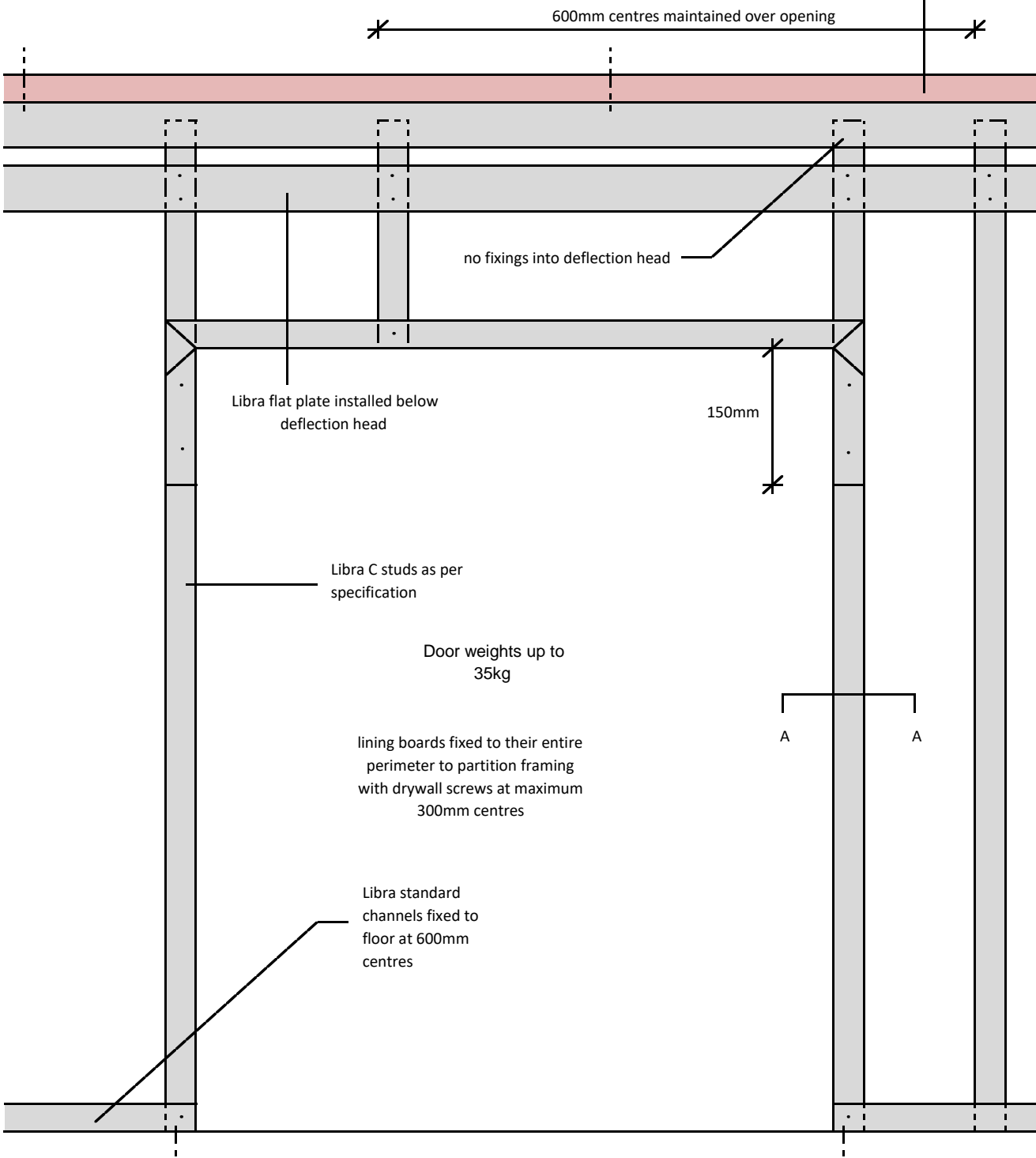

Notes: This drawing should be read in conjunction with the relevant sections of the manufacturers current product literature we would draw your attention to the Construction (Design and Management) Regulations 1994 and the Approved Code of Practice which detail the legal duties of clients, client's agents designers and contractors involved in construction projects.

for discussion purposes only / do not scale



project:

Typical Detail

initials:

ML

date:

21/5/2017

drg no:

ML/TYP/009

standard internal partition
light / medium door opening - section AA

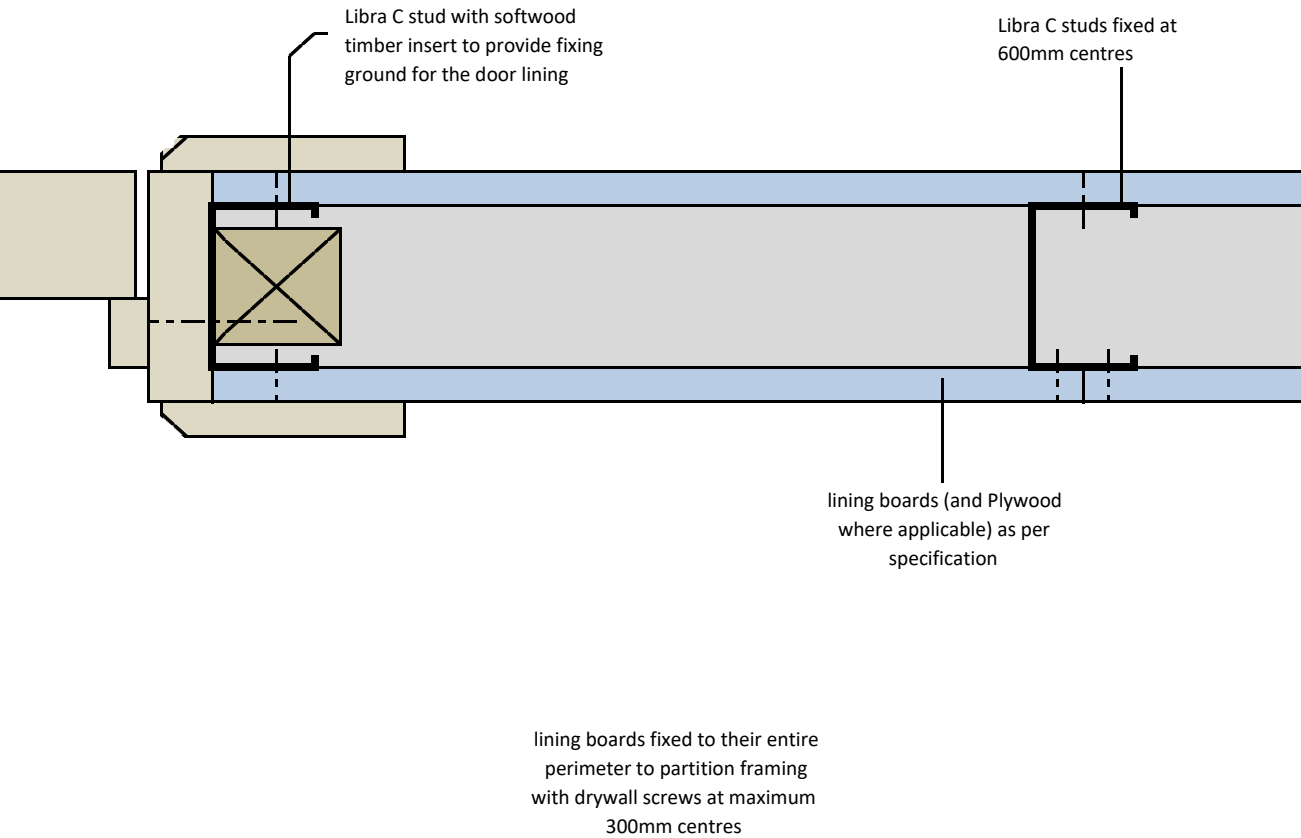

Notes: This drawing should be read in conjunction with the relevant sections of the manufacturers current product literature we would draw your attention to the Construction (Design and Management) Regulations 1994 and the Approved Code of Practice which detail the legal duties of clients, client's agents designers and contractors involved in construction projects.

for discussion purposes only / do not scale

	project: Typical Detail		
	initials: ML	date: 21/5/2107	drg no: ML/TYP/010

60 minutes To BS 476: Part 21 - For steels with a section factor up to 260 A/V(Hp/A)m

