



SILICONE DASH RECEIVER

Silicone Dash	Overcoating Silicone Dash		Silicone Spray Dash
<p>Incorporating silicone technology, Silicone Dash is normally applied over K Rend Base Coats as a background surface for dry dash or roughcast finishes.</p> <p>Require: 10-15kg / sq m approx. nominal 6-10mm thickness</p> <p> Kitemark Classifications: Compressive Strength: CS III Capillary Water Absorption Category: W2 Thermal Conductivity: P=50% -0.47</p>	<p>Specifically designed for refurbishment, Overcoating Silicone Dash is light and easy to use and gives excellent coverage over existing dry dash finishes. Surfaces to be over coated should be free from contamination (algae, oil and paint) and may require priming with R7 liquid acrylic prior to application.</p> <p>Require: 8-10kg / sq m approx. nominal 8-10mm thickness</p> <p> Kitemark Classifications: Compressive Strength: CS II Capillary Water Absorption Category: W2 Thermal Conductivity: P=50% - 0.26</p>		<p>This silicone enhanced dash receiver is designed to be spray applied by machine to increase the speed of application. Normally applied over a K Rend Base Coat, providing a surface for dry dash finishes.</p> <p>Require: 10-15kg / sq m approx. nominal 6-10mm thickness</p> <p> Kitemark Classifications: Compressive Strength: CS III Capillary Water Absorption Category: W2 Thermal Conductivity: P=50% -0.45</p>



Silicone Dash Receiver, Ivory, Co. Down.

K Rend Silicone Dash receivers are used over K Rend Base Coats. They are polymer modified and through coloured. These products are designed to have excellent workability and open time properties when used as backgrounds for 4-12mm dry dash or roughcast finishes. The finished thickness is normally determined by the size of the aggregate. Apply a uniform butter coat and throw the aggregate onto the surface while the render is still green.

Dash receiver

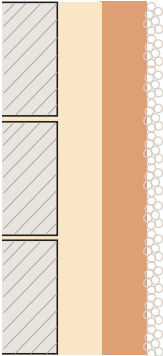

Base coat 8-10mm
Dash receiver 8mm
Dry dash

Please seek advice from our Technical Support Centre for a detailed specification.